

## CSL1102

## Mini Cornice LED Light

The Mini Cornice LED light utilises the latest advancement in LED technology to provide the highest quality of informally distributed light combined with substantial energy savings of typically 60%. These lights have been designed to be ligature resisting, very robust, & secure. Ideal to be used in high risk areas.



CSL1101A

Single Operation (On/Off)

CSL1101B

Twin Operation (On/Off/Night Light)

CSL1101C

Triple Operation (On/Off/Night Light/High Level)

(Add 'X' to above options if required) – 3 Hour  
Emergency Battery

**Any combination of the above are available.**

**Specification**

- Suitable for installation within cells & corridors.
- Lengths available up to 1200mm
- Three light levels can be incorporated (500, 300, 15 Lux)
- Emergency battery backup available.
- Home Office Approved.
- IP65 & IK10+ rated.
- Efficiency – Typically uses over 60% less energy than traditional fluorescent fittings.
- Zero Maintenance: reducing costs and the disruption caused by routine maintenance.
- Estimated lifetime of over 80,000 hours based on 12 hours use (Includes lumen depreciation)
- Glare free, uniformly distributed light output, achieving LG standard Lux levels.
- Operates voltages between 100-277 Volts AC.
- Ceiling to Wall mounted through the main body.
- When hard pick mastic is applied to outer body, you can still service the light if required.

**Finish**

- Metallic with a textured polycarbonate fascia.

## CSL1103

## Standalone Cornice LED Light

The Stand-Alone Cornice LED light utilises the latest advancement in LED technology to provide the highest quality of informally distributed light combined with substantial energy savings of typically 60%. These lights have been designed to be ligature resisting, very robust, & secure. Ideal to be used in high risk areas.



CSL1101A

Single Operation (On/Off)

CSL1101B

Twin Operation (On/Off/Night Light)

CSL1101C

Triple Operation (On/Off/Night Light/High Level)

(Add 'X' to above options if required) – 3  
Hour Emergency Battery

**Any combination of the above are available.**

**Specification**

- Suitable for installation within cells & corridors.
- Lengths – 1250mm
- Three light levels can be incorporated (500, 300, 15 Lux)
- Emergency battery backup available.
- Home Office Approved.
- IP65 & IK10+ rated.
- Efficiency – Typically uses over 60% less energy than traditional fluorescent fittings.
- Zero Maintenance: reducing costs and the disruption caused by routine maintenance.
- Estimated lifetime of over 80,000 hours based on 12 hours use (Includes lumen depreciation)
- Glare free, uniformly distributed light output, achieving LG standard Lux levels.
- Operates voltages between 100-277 Volts AC.
- Ceiling to Wall mounted through the main body.
- When hard pick mastic is applied to outer body, you can still service the light if required.

**Finish**

- Metallic with a textured polycarbonate fascia.

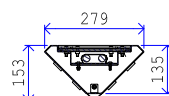
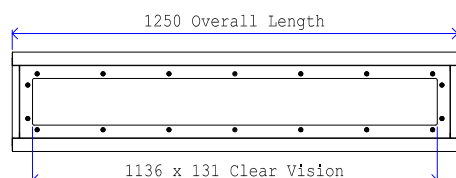

## Centre LED Light

CSL1104

The Centre LED light utilises the latest advancement in LED technology to provide the highest quality of informally distributed light combined with substantial energy savings of typically 60%. These lights have been designed to be ligature resisting, very robust, & secure. Ideal to be used in high risk areas.

### Specification

- Suitable for installation within cells & corridors.
- Dimensions – 1250 x 300 x 70 (L x W x H)
- Three light levels can be incorporated (500, 300, 15 Lux)
- Emergency battery backup available.
- Home Office Approved.
- IP65 & IK10+ rated.
- Efficiency – Typically uses over 60% less energy than traditional fluorescent fittings.
- Zero Maintenance: reducing costs and the disruption caused by routine maintenance.
- Estimated lifetime of over 80,000 hours based on 12 hours use (Includes lumen depreciation)
- Glare free, uniformly distributed light output, achieving LG standard Lux levels.
- Operates voltages between 100-277 Volts AC.
- Ceiling mounted through the main body.
- When hard pick mastic is applied to outer body, you can still service the light if required.



- CSL1101A  
Single Operation (On/Off)
- CSL1101B  
Twin Operation (On/Off/Night Light)
- CSL1101C  
Triple Operation (On/Off/Night Light/High Level)

(Add 'X' to above options if required) – 3 Hour Emergency Battery

**Any combination of the above are available.**

### Finish

- Metallic with a textured polycarbonate facia.

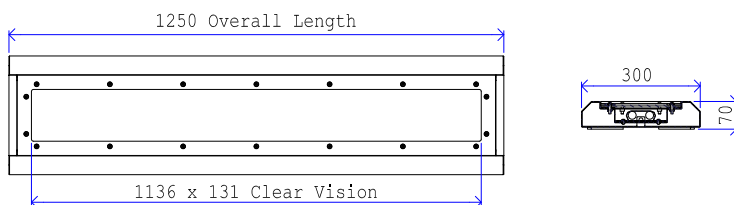

## Square LED Light

CSL1105

The Square LED light utilises the latest advancement in LED technology to provide the highest quality of informally distributed light combined with substantial energy savings of typically 60%. These lights have been designed to be ligature resisting, very robust, & secure. Ideal to be used in high risk areas.

### Specification

- Suitable for installation within cells & corridors.
- Dimensions – 350 x 350 x 70 (L x W x H)
- Available in 12W (28W comparable version)
- Three light levels can be incorporated (500, 300, 15 Lux)
- Emergency battery backup available.
- Home Office Approved.
- IP65 & IK10+ rated.
- Efficiency – Typically uses over 60% less energy than traditional fluorescent fittings.
- Zero Maintenance: reducing costs and the disruption caused by routine maintenance.
- Estimated lifetime of over 80,000 hours based on 12 hours use (Includes lumen depreciation)
- Glare free, uniformly distributed light output, achieving LG standard Lux levels.
- Operates voltages between 100-277 Volts AC.
- Ceiling mounted through the main body.
- When hard pick mastic is applied to outer body, you can still service the light if required.



- CSL1101A  
Single Operation (On/Off)
  - CSL1101B  
Twin Operation (On/Off/Night Light)
  - CSL1101C  
Triple Operation (On/Off/Night Light/High Level)
- (Add 'X' to above options if required) – 3 Hour Emergency Battery
- Any combination of the above are available.**

### Finish

- Metallic with a textured polycarbonate facia.

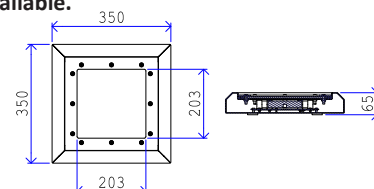

## CSL1106

## Retrofit LED Light

The Retrofit Tray LED light utilises the latest advancement in LED technology to provide the highest quality of informally distributed light combined with substantial energy savings of typically 60%. These lights will be designed bespoke to suit existing housings on site.

**Specification**

CSL1101A – Single Operation (On/Off)  
 CSL1101B – Twin Operation (On/Off/Night Light)  
 CSL1101C – Triple Operation (On/Off/Night Light/High Level)

(Add 'X' to above options if required) – 3 Hour Emergency Battery

Any combination of the above are available.

**Finish**

- Uniquely designed to suit bespoke housings where retrofit is an option.
- Three light levels can be incorporated (500, 300, 15 Lux)
- Emergency battery backup available.
- Efficiency – Typically uses over 60% less energy than traditional fluorescent fittings.
- Zero Maintenance: reducing costs and the disruption caused by routine maintenance.
- Estimated lifetime of over 80,000 hours based on 12 hours use (Includes lumen depreciation)
- Glare free, uniformly distributed light output, achieving LG standard Lux levels.
- Operates voltages between 100-277 Volts AC.

- PPC RAL9010 White.

## CSL1107

## IP65 Linear Surface Mounted Light

High impact-resistant surface mounted LED Linear light. These lights are ideally suited for prison, law court, police custody & immigration detention centre holding cells.

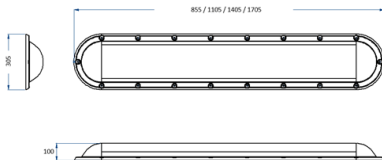
**Specification**

- High efficiency LED architecture. (100+ lumen/watt in clear lens).
- IP65 rated and IK10++ impact tested.
- Available in various lengths and outputs; 855mm (19,26 & 38w) 1105mm (28, 38 & 56w) 1405mm (38,51 & 75w) 1705mm (47,64 & 94w).
- Integral 3 hour emergency pack optional.
- Night light optional.
- 3000k or 4000k CCT colour options.
- Operating voltage 230 Volts AC.
- 1 year product warranty, 10 year lens guarantee.

**Finish**

- 1.5mm powder coated zintec base plate.
- 5mm Clear textured polycarbonate lens.
- Lens secured by M6 TORX security screws.

## CSL1108

## IP65 Linear Surface Mounted Light

High impact-resistant surface mounted LED Linear light. These lights are ideally suited for prison, law court, police custody & immigration detention centre holding cells.

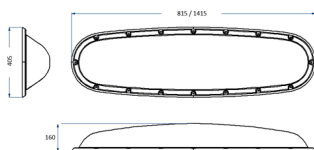
**Specification**

- High efficiency LED architecture. (100+ lumen/watt in clear lens).
- IP65 rated and IK10++ impact tested.
- Available in various lengths and outputs; 815mm (19,26 & 38w) 1415mm (38,51 & 75w).
- Integral 3 hour emergency pack optional.
- Night light optional.
- 3000k or 4000k CCT colour options.
- Operating voltage 230 Volts AC.
- 1 year product warranty, 10 year lens guarantee.

**Finish**

- 1.5mm powder coated zintec base plate.
- 5mm Clear textured polycarbonate lens.
- Lens secured by M6 TORX security screws.

## IP65 Emergency Bulkhead Surface Mounted Light

CSL1109

High impact-resistant surface mounted Emergency LED Bulkhead light. Suitable for corridors, service areas, stairwells, plant rooms & exit doors in high risk areas.

### Specification

- Fully compliant with IEC 60598-2-22:2014 & IEC 60598-1:2014.
- Integral 3 hour emergency pack.
- Maintained and non-maintained, Basic Test, Self-Test and Automatic Test options.
- High efficiency LED architecture.
- IP65 rated and IK10++ impact tested.
- Dimension and output; 475mm (19w maintained operation).
- 3000k or 4000k CCT colour options.
- Operating voltage 230 Volts AC.
- 1 year product warranty, 10 year lens guarantee.
- Conduit mounting bracket available.

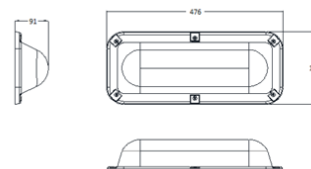

### Finish

- 1.5mm powder coated zintec base-plate.
- 5mm Opal textured polycarbonate lens.
- Lens secured by M6 TORX security screws.

## Standard Cell Linear Surface Mounted Light

CSL1110

Ministry of Justice (MoJ) approved anti-ligature vandal resistant luminaire suitable for 'Standard' Cellular accommodation in accordance with STD/E/SPEC/021.

### Specification

- High efficiency LED architecture.
- Light output consistent with MOJ specified level.
- IP54 rated and IK10++ impact tested.
- Available in two lens lengths; 975mm (37w) 1275mm (35w).
- Night light on separate circuit.
- 3000k colour.
- Operating voltage 230 Volts AC.
- 1 year product warranty, 10 year lens guarantee.

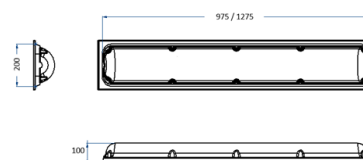
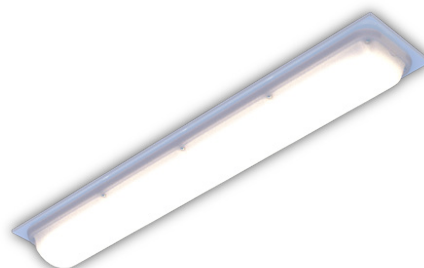

### Finish

- 1.5mm powder coated zintec surface mounting & base plate.
- 5mm Opal textured polycarbonate lens.
- Lens secured by M6 TORX security screws.

## Safer Cell Linear Surface Mounted Light

CSL1111

Ministry of Justice (MoJ) approved anti-ligature vandal resistant luminaire suitable for 'Standard' Cellular accommodation in accordance with STD/E/SPEC/022.

### Specification

- High efficiency LED architecture.
- Light output consistent with MOJ specified level.
- IP65 rated and IK10++ impact tested.
- Available in two lens lengths; 815mm (84w) 1415mm (106w).
- Two separate daytime circuits providing low, medium and high output light levels.
- Night light on separate circuit.
- 3000k colour.
- Operating voltage 230 Volts AC.
- 1 year product warranty, 10 year lens guarantee.

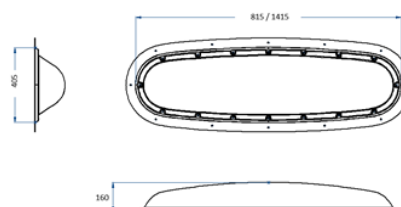

### Finish

- 3mm powder coated steel protective cover band.
- 1.5mm powder coated zintec surface mounting base-plate.
- 8mm Opal textured polycarbonate lens.
- Lens secured by M6 TORX security screws.