

## CSL0951

## Shower Panel Wall Mounted

**CSL0951E**

Electrical Operation

**CSL0951M**

Mechanical Operation

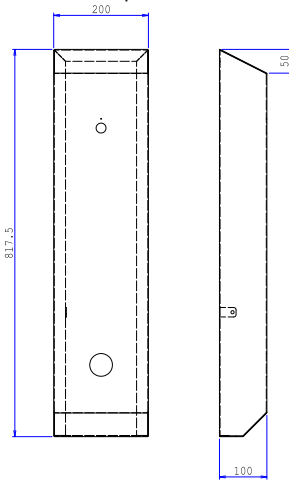
**Specification**

- Constructed in one piece from 2mm grade 304 stainless steel.
- Ligature resisting vandal proof spray head.
- Exposed surfaces polished to a satin finish.
- Supplied with either a 30 second time flow mechanical valve button or a electrical button and solenoid valve to be used in conjunction with a shower control unit CSL0986.

**Finish**

- Satin polished 304 stainless steel.

**Options**

- Electrical or Mechanical.
- Grade 316 stainless steel available to order.
- Stove enamelled.

**NOTE - This product requires temperature controlled water supply (CSL0976). CSL0951E requires an electronic control unit (CSL0986C or CSL0986D).**

## CSL0952

## Shower Panel Recessed

**CSL0952E**

Electrical Operation

**CSL0952M**

Mechanical Operation

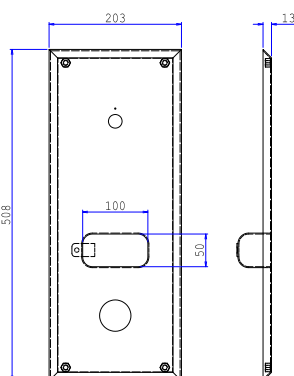
**Specification**

- Constructed in one piece from 2mm grade 304 stainless steel.
- Ligature resisting vandal proof spray head.
- Exposed surfaces polished to a satin finish.
- Supplied with either a 30 second time flow mechanical valve button or a electrical button and solenoid valve to be used in conjunction with a shower control unit CSL0986C/D.
- Integrated recessed soap dish.
- All edges of the faceplate are chamfered to avoid ligature attachment.

**Finish**

- Satin polished 304 stainless steel.

**Options**

- Electrical or Mechanical.
- Grade 316 stainless steel available to order.
- Stove enamelled.

**NOTE - This product requires temperature controlled water supply (CSL0976). CSL0952E requires an electronic control unit (CSL0986C or CSL0986D).**