

Steel Cell Desk

CSL0552

Purpose

A robust steel cell desk suitable for use in a prison cells.

Specification

- Desk constructed from pressed 3mm thick mild steel sheet with no sharp edges.
- Welded steel brackets secured to wall with tamper resistant expansion bolts.

Finish

- Polyester paint Oyster Grey.

Options

- Other polyester colours available.
- Desk can be provided in stainless steel.
- Different lengths can be provided.

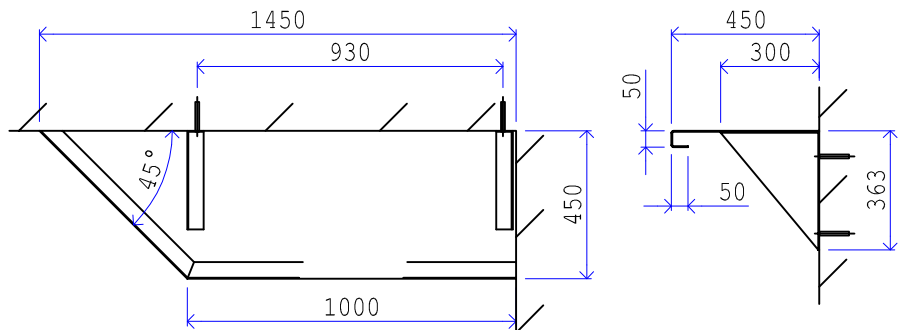
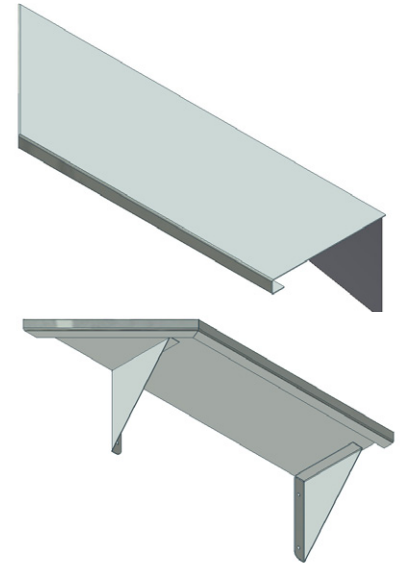

Steel Cell Writing Table

CSL0553

Purpose

A robust steel cell writing table suitable for use in prison cells.

Specification

- Table is constructed from pressed 3mm thick mild steel sheet with no sharp edges.
- Fixed directly to wall with tamper resistant expansion bolts.

Finish

- Polyester paint Oyster Grey.

Options

- Other polyester colours available.
- Table can be provided in stainless steel.
- Different lengths can be provided.

