

WC Pan - Corner

CSL0903

Specification

- Constructed in one piece without joints or crevices from 2mm thick grade 304, stainless steel.
- Ligature resisting security flushing rim with a gap of less than 2mm.
- Filled with sound deadening fire retardant expanding foam to prevent drumming.
- Supplied with concealed floor fixing plate and four M12 x 330mm long fixing bolts.
- Ergonomically designed contoured seat.

Finish

- External surface of bowl is polished to a satin finish.
- Internal surface polished to a ultra smooth finish that is hygienic, easy to clean and resistant to scale build-up and deposits.

Options

- Also available in grade 316 stainless steel to order.
- Stove enamelled.

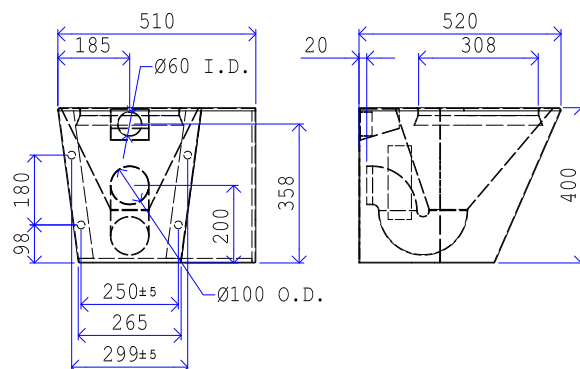

CSL0903R
(as shown)
Corner Pan Right

CSL0903L
Corner Pan Left

Compatible With

Pneumatic system
CSL0981 Cistern
CSL0982 Push Button

Electrical system
CSL0981 Cistern
CSL0983 Electrical Control Button
CSL0985 Electrical Syphon
CSL0986 Electrical Control Box

Other
CSL0915 Dry Cell Toilet Cover

WC Pan - Disabled

CSL0904

Specification

- Constructed in one piece without joints or crevices from 2mm thick grade 304, stainless steel.
- Ligature resisting security flushing rim with a gap of less than 2mm.
- Filled with sound deadening fire retardant expanding foam to prevent drumming.
- Removable side panel to allow for easy outlet access.
- Supplied with concealed floor fixing plate and four M12 x 330mm long fixing bolts.
- Ergonomically designed contoured seat.

Finish

- External surface of bowl is polished to a satin finish.
- Internal surface polished to a ultra smooth finish that is hygienic, easy to clean and resistant to scale build-up and deposits.

Options

- Also available in grade 316 stainless steel to order.
- Stove enamelled.

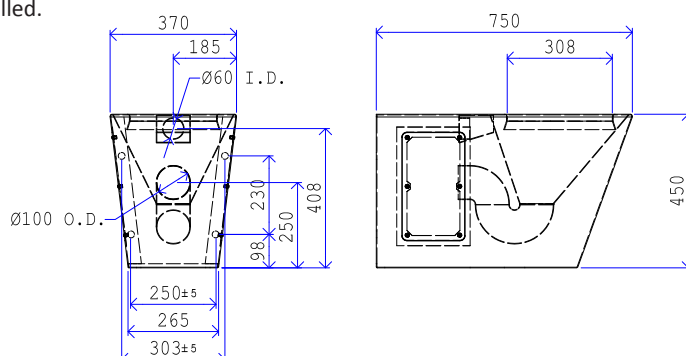

Compatible With

Pneumatic system
CSL0981 Cistern
CSL0982 Push Button

Electrical system
CSL0981 Cistern
CSL0983 Electrical Control Button
CSL0985 Electrical Syphon
CSL0986 Electrical Control Box

Other
CSL0915 Dry Cell Toilet Cover
CSL1011 Doc M Pack