

WC Pan - Close Coupled Suite

CSL0907

Specification

- Constructed in one piece without joints or crevices from 2mm thick grade 304 stainless steel.
- Ligature resisting security flushing rim with a gap of less than 2mm.
- Self draining and an ergonomically designed contoured seat. Filled with sound deadening fire retardant expanding foam to prevent drumming.
- Removable cistern top with tamper proof fixings.
- Removable side panel to allow for easy outlet access.
- Supplied in electronic or pneumatic operation.

Finish

- External surface of bowl is polished to a satin finish.
- Internal surface polished to a ultra smooth finish that is hygienic, easy to clean and resistant to scale build-up and deposits.

Options

- Also available in grade 316 stainless steel to order.
- Stove enamelled.

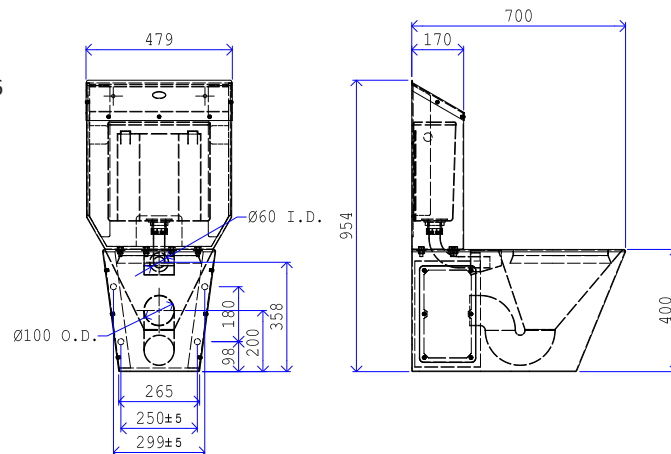

CSL0907E
Electrical Operation

CSL0907P
Pneumatic Operation

CSL0907DE
Disabled Electrical Operation

CSL0907DP
Disabled Pneumatic Operation

WC Pan - Euro Horizontal Outlet

CSL0908

Specification

- Constructed in one piece without joints or crevices from 1.6mm grade 304 stainless steel.
- Filled with sound deadening fire retardant expanding foam to prevent drumming.
- Self draining flushing rim for an easy cleaning of the pan.
- Supplied with four M12 x 330mm long fixing bolts.
- Curved sides.

Finish

- External surface of bowl is polished to a satin finish.
- Internal surface polished to a ultra smooth finish that is hygienic, easy to clean and resistant to scale build-up and deposits.

Options

- Also available in handicapped 500mm height.

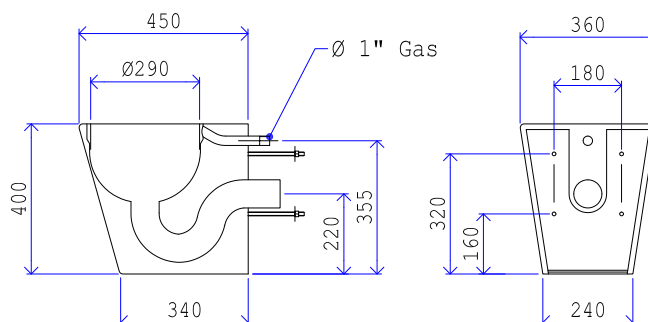

CSL0908H
Horizontal Standard

CSL0908D
Horizontal Handicapped

Compatible With

Pneumatic system
CSL0981 Cistern
CSL0982 Push Button

Electrical system
CSL0981 Cistern
CSL0983 Electrical Control Button
CSL0985 Electrical Syphon
CSL0986 Electrical Control Box